

- Insulated ducts
- ISDF - Foam ducts
- Roof- and wall terminals



Insulated roof caps with pass-through for ISDF Ducts type ISDF DD

Insulated roof terminals with pass-through for ISDF-ducts

Brand

- Ubbink

Application

- Universal roof pass-throughs for mechanical ventilation systems
- For flat and pitched roofs 15-55°
- Applicable with Ø200-180-160-150mm

Specifications

- For pitched roofs with stepless adjustment or for flat roofs
- Perpendicular pass-through insures easy and airtight mounting
- 3 in 1 integrated solution: roof cap, flashing and adaptive reduction
- Smart design prevents infiltration of snow and rain
- Outstanding pressure drop performance
- Without thermal bridges

Composition

- Roof cap from polypropylene - PP
- Insulation in expanded polyethylene - EPE
- Flashing pitched roof: Universal flashing of lead substitute (600 mm x 600 mm)
- Flashing flat roof: Aluminum flashing
- Ø200mm version with reduction to Ø180mm
- Ø1600mm version with reduction to Ø150mm

Accessories

- **ISDF** insulated ducts
- **ISDF FB** mounting brackets

Order example

ISDF DD-P 160/150

Explanation :

ISDF = Range of insulated ducts

DD= Insulated pass-through + roof cap and flashing

P=Flat roof H= Pitched roof

160/150 = Inner diameter Ø160mm + included reduction Ø150mm

Symbols and specifications

- V_k = Effective average airspeed through the grille in m/s
- P_s = Static pressure loss through the grille in Pa
- IN = Aspiration outside air
- OUT= Air to outside

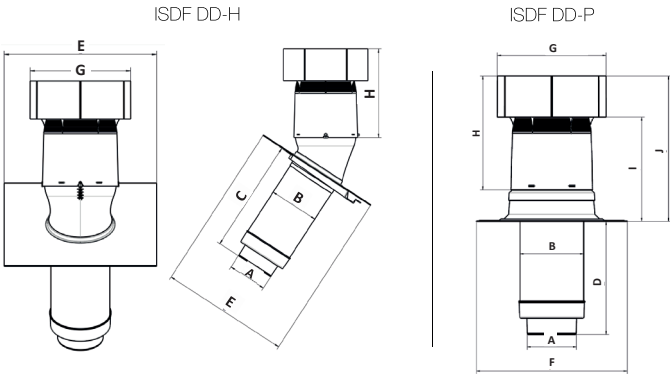

	Dimension									
	A [mm]	B[mm]	C[mm]	D[mm]	E[mm]	F[mm]	G[mm]	H[mm]	I[mm]	J[mm]
ISDF-DD 160 (150)	150	192	518	425	600	550	396	416	381	531
ISDF-DD 200 (180)	180	232	531	413	600	550	396	416	381	531